

EXOCARB® WXL-CR-EDS

Premium Performance Carbide End Mills with OSG's Proprietary WXL® Coating

List 3870

EXOCARB® WXL-CR-EDS



SPEED FEED
7

CARBIDE

WXL

2 FLUTE

30°



SHANK
h6

STUB

REG

PACKED
1 PIECE

Cutting Diameter Tolerance	
1/16" ≤ D ≤ 1/2"	+0/-0.0008"



EDP Number		Mill Diameter	Corner Radius	Length of Cut	Neck Length	Neck Diameter	Overall Length	Shank Diameter	Type
		D (Inch)	R (Inch)	Lc (Inch)	L1 (Inch)	d1 (Inch)	L (Inch)	d (Inch)	
38700012	●	1/16	0.015	3/32	0.1641	0.0605	2	1/8	1
38700112	●	1/16	0.020	3/32	0.1641	0.0605	2	1/8	1
38700212	▲	3/32	0.015	9/64	0.1976	0.0898	2	1/8	1
38700312	▲	3/32	0.020	9/64	0.1976	0.0898	2	1/8	1
38700412	●	1/8	0.015	9/32	-	-	2 1/2	1/8	2
38700512	●	1/8	0.020	9/32	-	-	2 1/2	1/8	2
38700612	●	1/8	0.030	9/32	-	-	2 1/2	1/8	2
38700712	●	3/16	0.015	7/16	-	-	3 1/8	3/16	2
38700812	●	3/16	0.020	7/16	-	-	3 1/8	3/16	2
38700912	●	3/16	0.030	7/16	-	-	3 1/8	3/16	2
38701012	●	1/4	0.015	9/16	-	-	3 1/2	1/4	2
38701112	●	1/4	0.020	9/16	-	-	3 1/2	1/4	2
38701212	●	1/4	0.030	9/16	-	-	3 1/2	1/4	2
38701312	●	1/4	0.060	9/16	-	-	3 1/2	1/4	2
38701412	●	5/16	0.020	3/4	-	-	4	5/16	2
38701512	●	5/16	0.030	3/4	-	-	4	5/16	2
38701612	●	5/16	0.060	3/4	-	-	4	5/16	2
38701712	●	3/8	0.020	7/8	-	-	4	3/8	2
38701812	●	3/8	0.030	7/8	-	-	4	3/8	2
38701912	●	3/8	0.060	7/8	-	-	4	3/8	2
38702012	●	1/2	0.030	1	-	-	4 1/4	1/2	2
38702112	●	1/2	0.060	1	-	-	4 1/4	1/2	2

● Stocked ○ Available Upon Request; MOQ May Apply ▲ Globally Stocked



Type 1

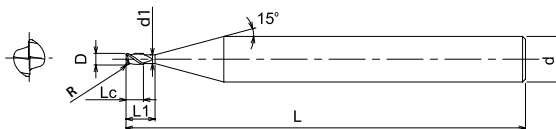

Type 2

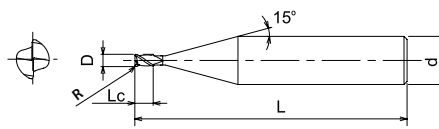

P					M			K	N		S		H			
Steel					Stainless Steel			Cast Iron	Non-Ferrous		HRSA		Hardened Steel			
Carbon Steel			Alloy Steel	Die Steel	300	400	17-4 PH		Aluminum		Nickel Alloy	Titanium				
Low	Medium	High						6061	Casting	Inconel			6Al4V (30 HRC)	~35 HRC	35-45 HRC	45-50 HRC
1010	1035	1065	4140	4340	7075											
○	○	○	○	○	○	○	○	○	○	○	○	○	○	○	○	

○ Good ○ Best

